

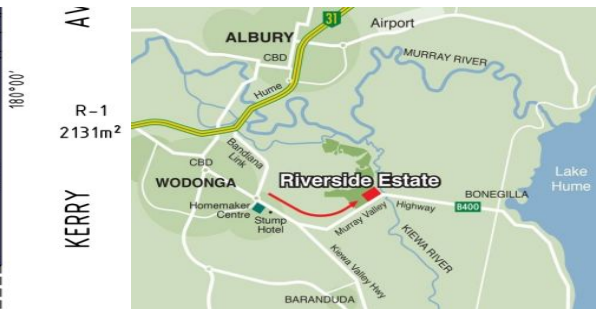

Quality living by the river

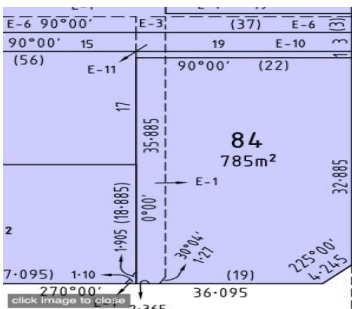

**84/2 Wenden Avenue Wodonga VIC**

Riverside Estate is a truly special place. Without doubt, it is destined to be the most sought after address in the Albury Wodonga region. There is practically nowhere else between here and South Australia where you can buy blocks like this with river frontage. For the first time, discerning home buyers can purchase residential land with a frontage to the mighty Murray and meandering Kiewa Rivers.

Imagine your family enjoying some of the unique features of Riverside Estate in the years ahead. Exercise will take on a new meaning when you can breathe the fresh air along the Estate's 1.6km looped walkway. This path will hug the banks of a quintessential Australian creek, sensitively revegetated to remove any signs of development. And nature lovers take note: your biggest challenge will be deciding which of the many tracks into

**Price** : \$ 128,000  
**Land Size** : 785 sqm  
**View** : <https://www.wodongarealestate.com.au/sale/vic/north-eastern/wodonga/residential/land/5835941>



**Margy Meehan**  
0260 561 888