



29 Lightwood Drive Wodonga VIC

3 2 2

Deceiving size home from the street that you have to inspect inside to appreciate. Modern appointments throughout include-

- * Entertainers kitchen with stainless steel appliances and dishwasher
- * Large open style living spilling to fabulous outside pitched pergola
- * Main bedroom with en-suite and walk in robe, bedrooms 2 & 3 with built in robes
- * Comforts of ducted heating & cooling
- * Double lock up garage with remote, internal & rear access
- * 741m2 block with room rare to many homes today
- * Quiet position with easy access to freeway, shops & access to Central Wodonga
- * Currently let at \$320 per week or can be purchased with vacant possession

Land Size : 741 sqm
View : <https://www.wodongarealestate.com.au/sale/vic/north-eastern/wodonga/residential/house/5835957>

FLOOR PLAN 1:100

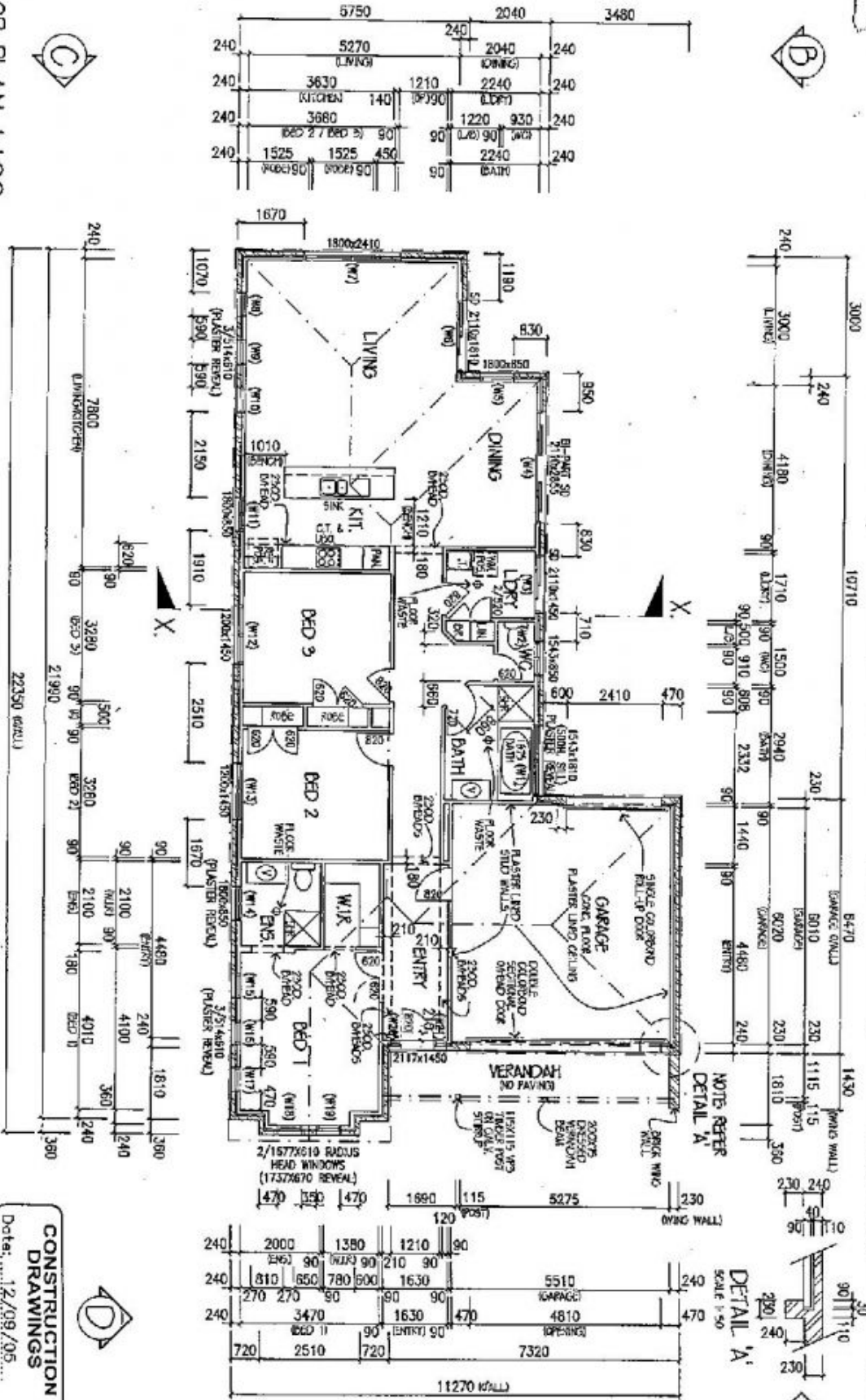

CONSTRUCTION DRAWINGS
Date: 12/09/05

NOTES:
 1. WALL THICKNESS AND PENETRATION OVER.
 2. WINDOW SIZES SHOWN ARE SUPPLYING FRAME SIZES.
 3. ALL FOR ALUMINUM - CONSIDERING FOR THERMALLY
 4. BREAKING TO COMPLY WITH A.S. 1288-1994
 5. CLASS IN BAY WINDOWS, & WITH A.S. 4025-1992 FOR
 6. WINDOW SIZES TO PROVIDE COVER BONDS TO
 7. ALL OTHER WINDOWS (SIZES).
 8. DOOR TO BE RED OAK MR. 1200 RHTD
 9. DOOR TO BE RED OAK MR. 1200 RHTD
 10. ALL DOOR COULD BE REMOVED IN
 11. ACCORDANCE WITH DETAILS.

NO.	DATE	REVISION	BY	DATE	REVISION	BY
1	12/09/05	AS	VOI	12/09/05	GL	
2						
3						
4						
5						

NO.	DATE	REVISION	BY	DATE	REVISION	BY
1	14/05/04	SA	VOI	14/05/04	GL	
2						
3						
4						
5						

AKIRA 20
 VICTORIAN
 24 L
 FLOOR PLAN
 ENERGY EFFICIENCY RATED

today!
 SERIES
metricon

OWNER: MR. T. DONELAN
 LOT 4 LIGHTWOOD DRIVE
 WOODONGA
 JOB NO: 211213
 DATE: 07/07/05
 EC DATE: 12/09/05
 ASST: MR. P. O'LEARY
 PERMIT NO: 0187405
 SHEET: 2 of 8