



**11 Kerferd Court Wodonga VIC**

3 2 2

This grand, privately secluded home has been designed for the professional to work from home with its own individual entrance, or the same living space is perfect as a teenage retreat/rumpus/bed room or similarly would be very comfortable for a live in relation. Set on a glorious 1644m<sup>2</sup> allotment with the beautiful Federation hills behind you the large yard offers unlimited options also. The many extra features include-

- \* Solid Blackwood kitchen with walk in pantry and fridge included
- \* Separate spacious sunken lounge and tiled family room
- \* Comforts of gas ducted heating and evaporative cooling throughout
- \* Relaxing salt chlorinated jet pool opposite a huge paved entertaining area
- \* Double garage with remote, internal and rear access

**Price** : \$ 390,000  
**Land Size** : 1644 sqm  
**View** : <https://www.wodongarealestate.com.au/sale/vic/north-eastern/wodonga/residential/house/5835961>



**Clinton Harvey**  
0260 561 888

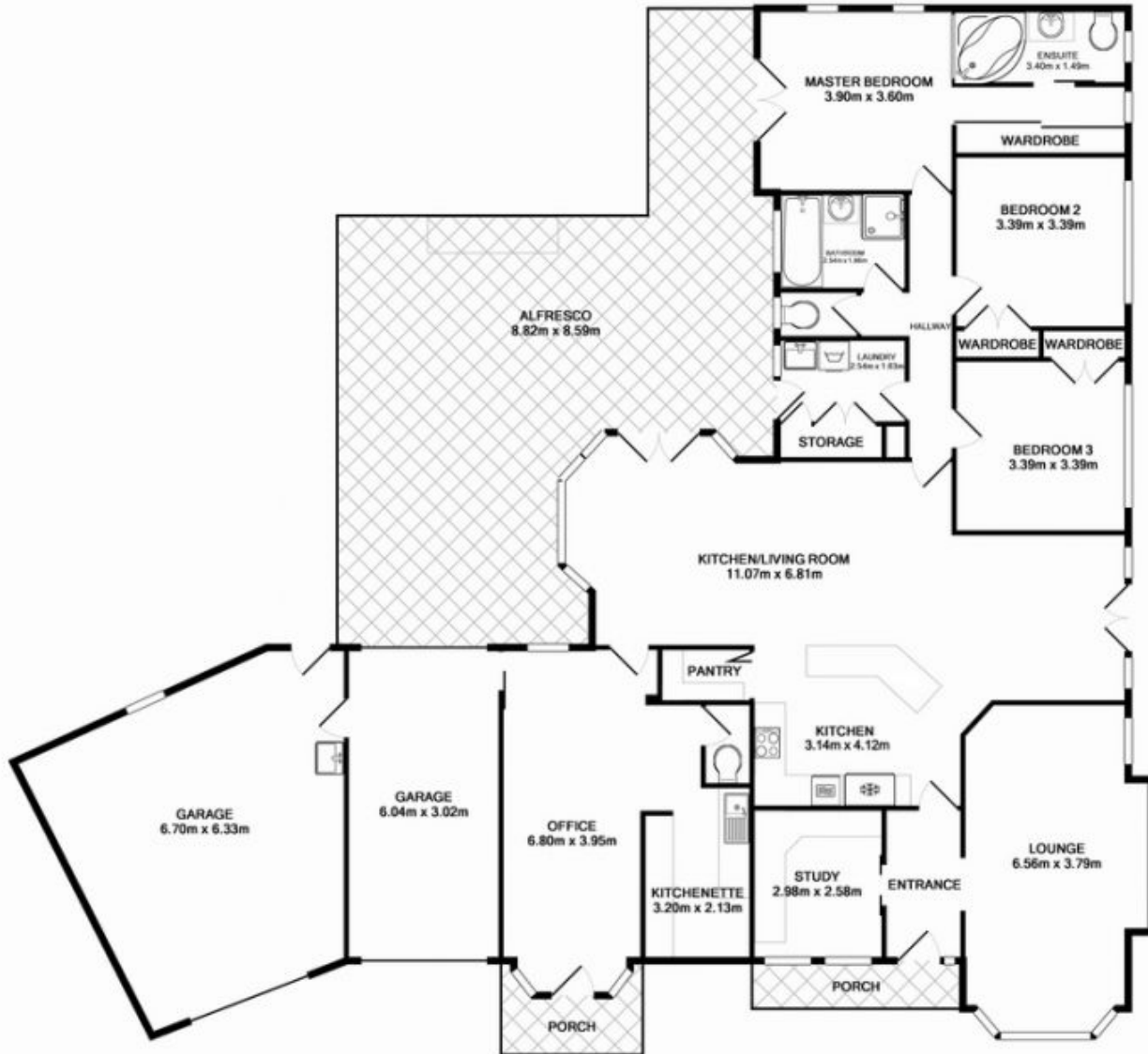

TOTAL APPROX. FLOOR AREA 237.3 SQ.M. (2554 SQ.FT.)  
Measurements are approximate. Not to Scale. For illustrative purposes only.  
Made with Metropix 02014