



### 14 Park View Close Wodonga VIC

4 2 2

Ever dreamed of overlooking a peaceful park setting in a quiet court location? Look no further! This beauty offers:

- \* Four bedrooms
- \* Functional kitchen with dishwasher
- \* Formal lounge and dining with large windows
- \* Ducted heating and cooling for year round comfort
- \* Large all weather entertaining pergola
- \* Double carport
- \* Large 1003m<sup>2</sup> allotment
- \* Pool
- \* Additional shed, rear yard access to beautiful walking track

**Price** : \$ 310,000  
**Land Size** : 1003 sqm  
**View** : <https://www.wodongarealestate.com.au/sale/vic/north-eastern/wodonga/residential/house/5836405>

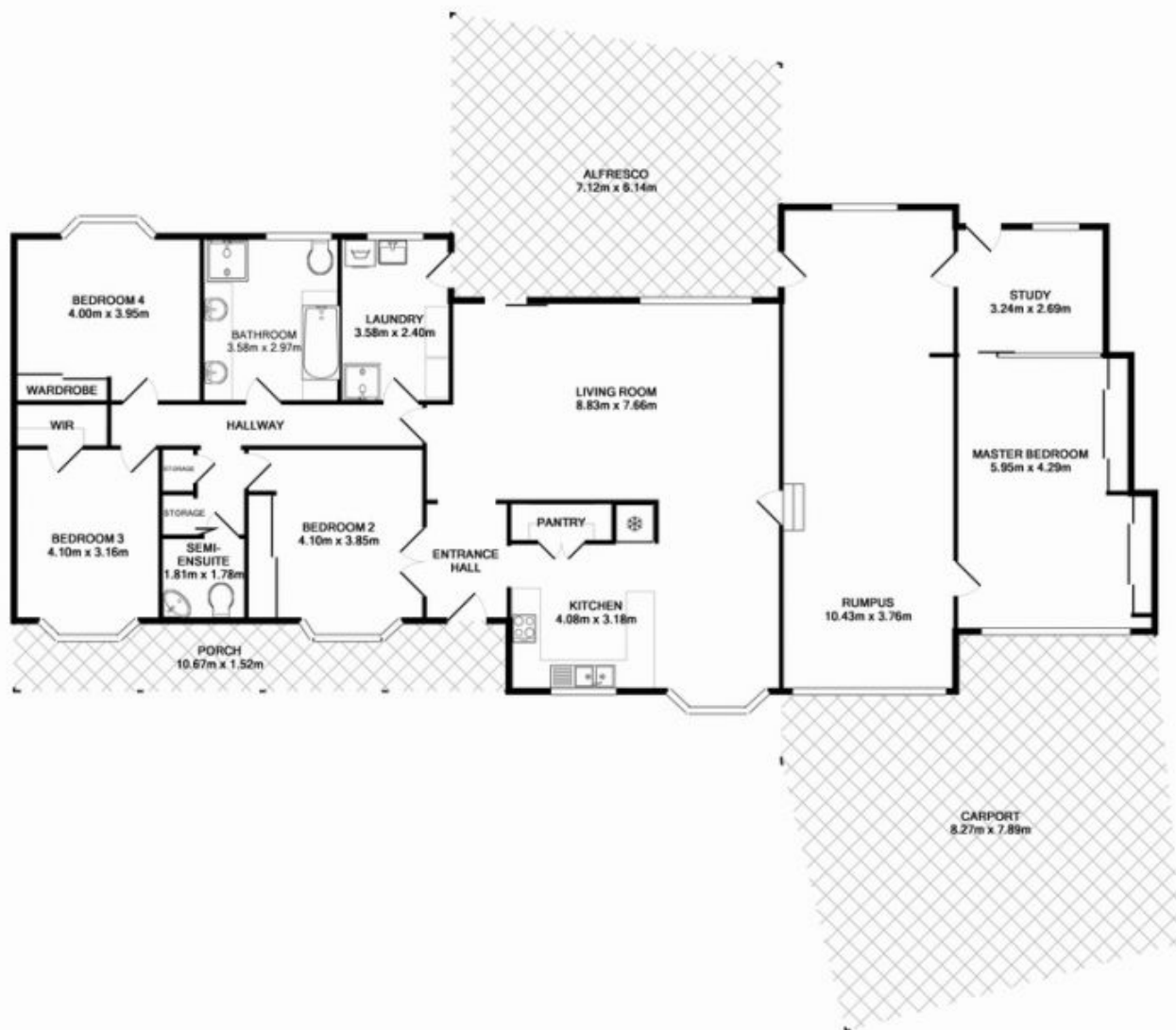

Measurements are approximate. Not to Scale. For illustrative purposes only.