



### 11 Draw Court Wodonga VIC

3 2 2

A generous size three bedroom home plus study close to TAFE/LaTrobe University and Wodonga Golf Course.

Features include:

- \* Fabulous country style kitchen
- \* Formal lounge/dining
- \* Separate tiled family dining area
- \* Ducted heating and cooling plus split system
- \* Low maintenance 760m<sup>2</sup> allotment with back yard access
- \* Double lock garage plus additional workshop and shed

**Price** : \$ 320,000

**Land Size** : 760 sqm

**View** : <https://www.wodongarealestate.com.au/sale/vic/north-eastern/wodonga/residential/house/5836430>

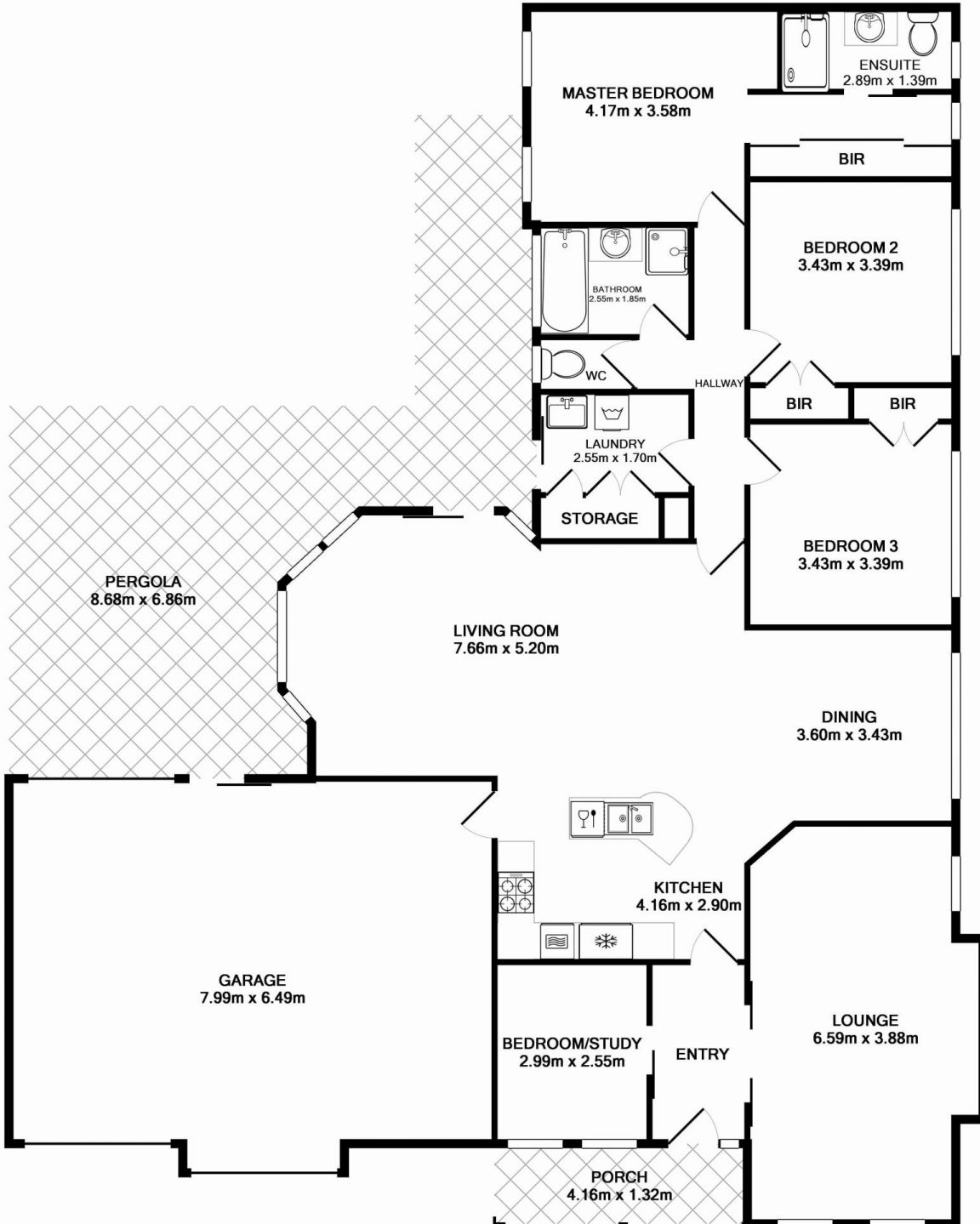
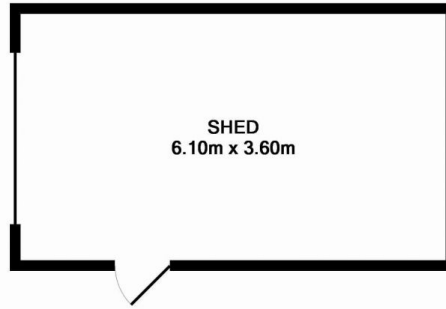

Measurements are approximate. Not to Scale. For illustrative purposes only.