



2 Canary Court Wodonga VIC

3 1 2

Quality Alatalo built family home is a quiet court. Features include:

- * Three spacious bedrooms with built in robes
- * Timber kitchen with plenty of cupboard space for mum
- * Dishwasher, gas cooktop and gas oven
- * Ducted evaporative cooling and two gas wall furnaces
- * Relax in the spa bath
- * Covered outdoor entertaining area and brick BBQ
- * Double lock up garage with rear access and large 5 x 5 metre shed
- * Good size backyard with views (approx 983m²)
- * For investors - expected rent of \$320-\$335 per week - 5.6% - 5.86% return
- * Here today - Gone tomorrow

Price : \$ 295,000
Land Size : 983 sqm
View : <https://www.wodongarealestate.com.au/sale/vic/north-eastern/wodonga/residential/house/5836543>

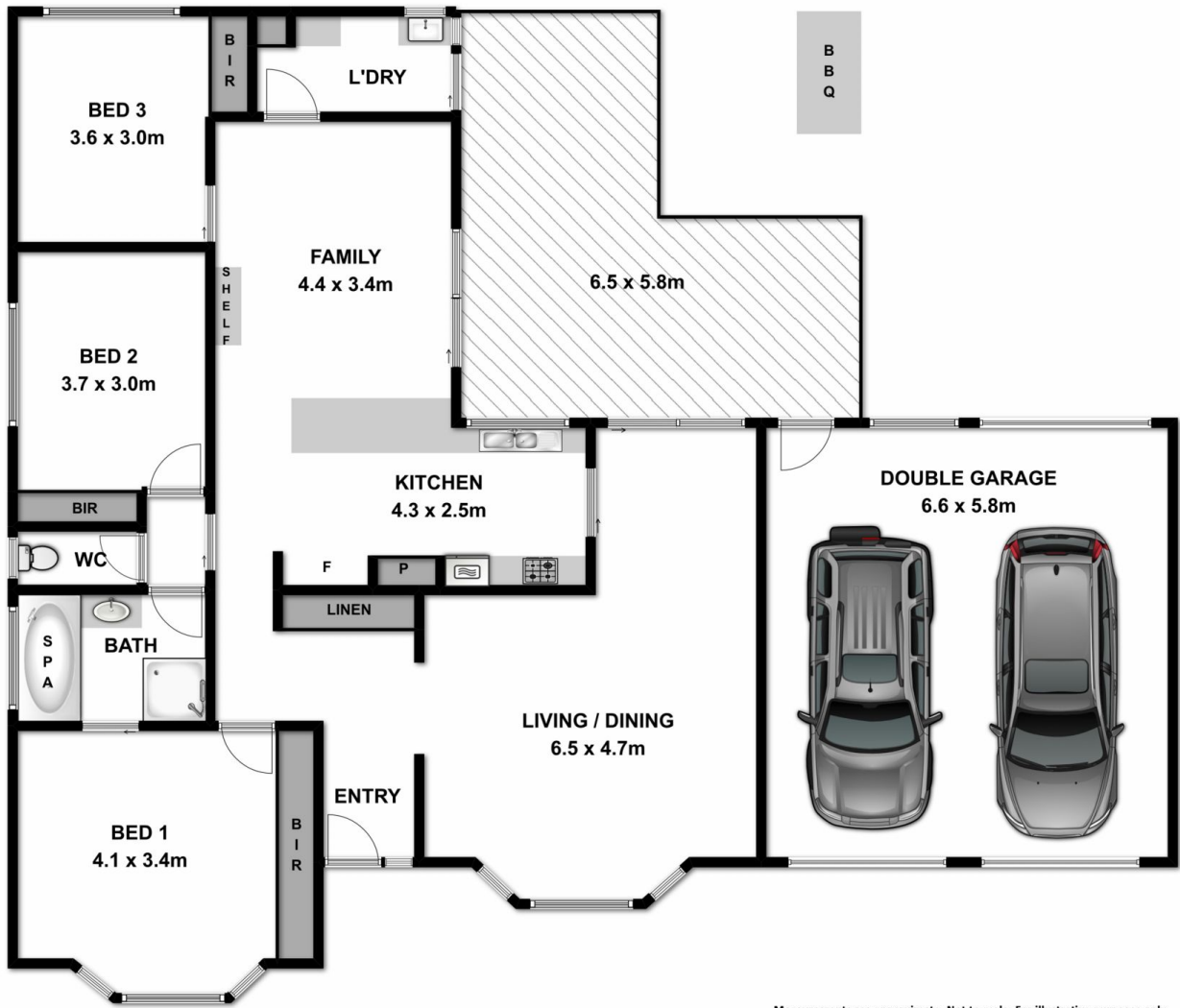

Measurements are approximate. Not to scale. For illustrative purposes only.