



**4 McLean Crescent Wodonga VIC**

3 2 2

Great opportunity to enter the market. This sought after location will be sure to attract young families, first home buyers and investors. Features include:

- \* Popular Federation Park Estate
- \* Large main bedroom with walk in robe and en-suite
- \* Bedrooms 2 & 3 are spacious with built in robes
- \* Two living areas plus kitchen and dining
- \* Ducted heating and cooling
- \* Electric cooking and gas hot water
- \* Spacious laundry
- \* Outdoor entertaining area
- \* Double lock up garage with rear access
- \* Good size yard with room for large shed (STCA)

**Price** : \$ 257,000  
**Land Size** : 830 sqm  
**View** : <https://www.wodongarealestate.com.au/sale/vic/north-eastern/wodonga/residential/house/5836563>

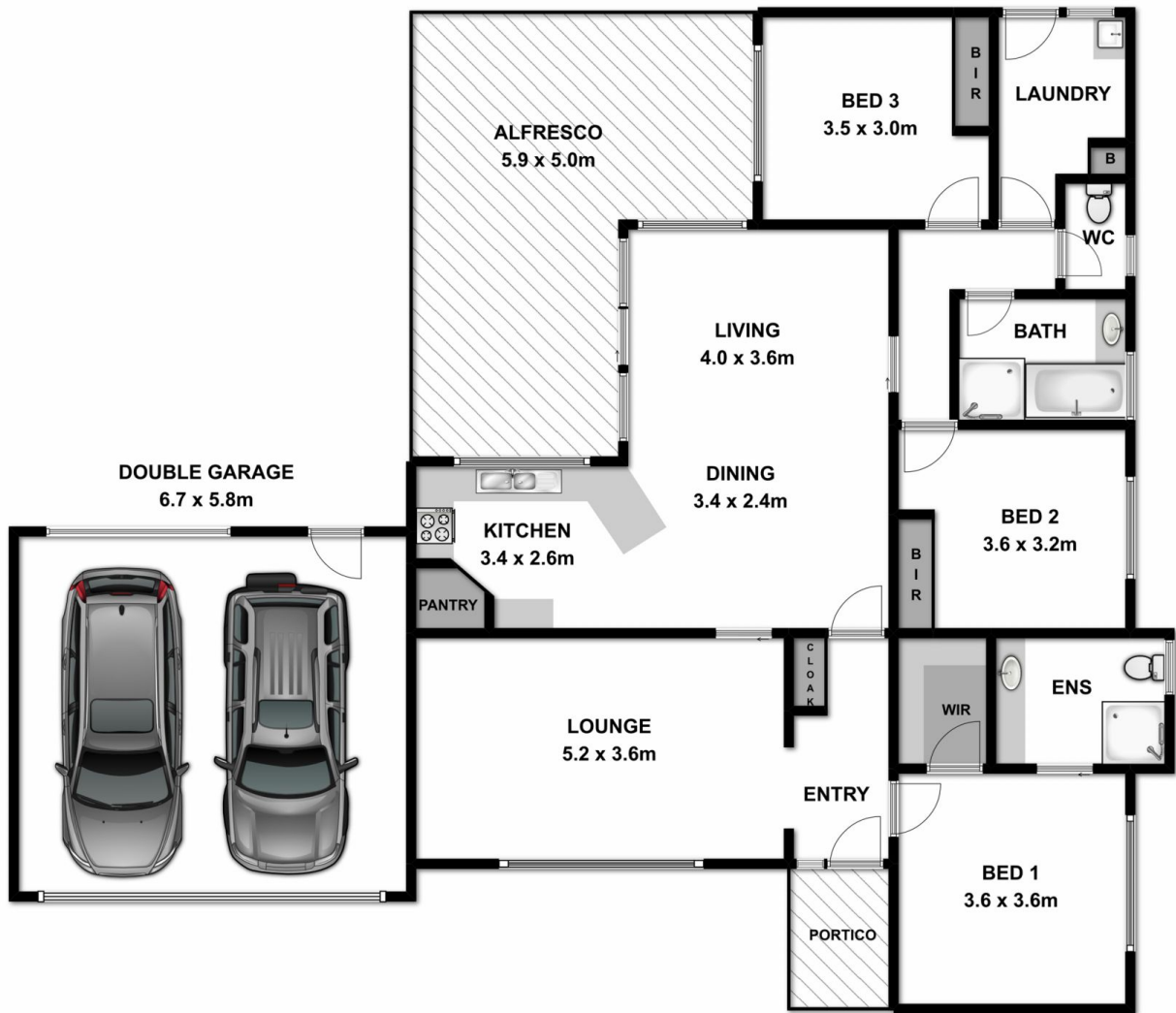

Measurements are approximate. Not to scale. For illustrative purposes only.