



348 Lawrence Street Wodonga VIC

3 2 1

This three bedroom home close to schools, shops and sporting facilities is an ideal opportunity for either a first home or investment property to add to your portfolio.

Currently leased at \$295.00 per week the property offers investors a 6.4% return.

The home has a large separate living with gas heating, kitchen / meals area opening to a paved outdoor area, en-suite to main bedroom and ducted cooling throughout.

A lockup garage and low maintenance gardens complete the home.

Price : \$ 230,000

View : <https://www.wodongarealestate.com.au/sale/vic/north-eastern/wodonga/residential/house/5836649>

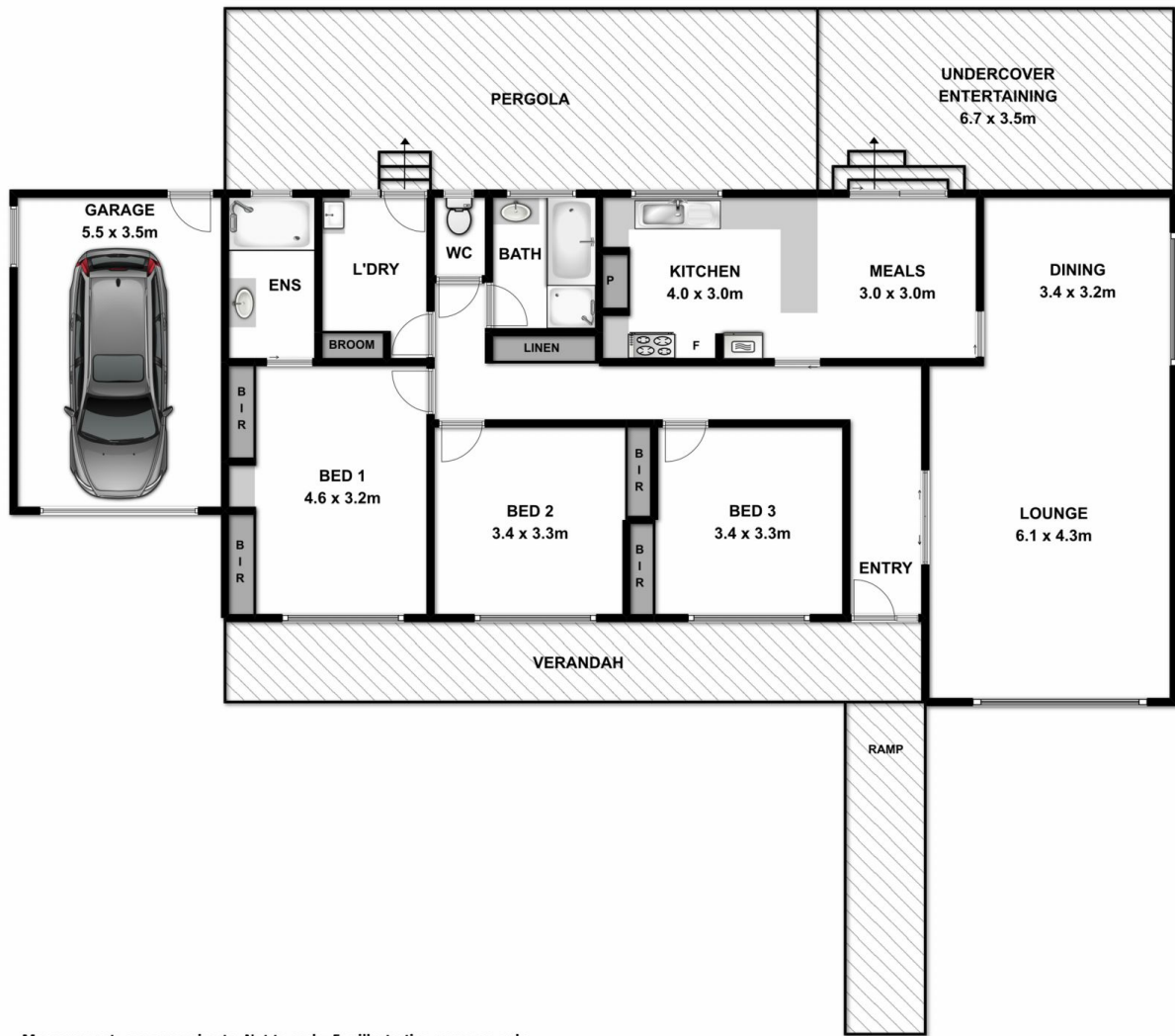

Measurements are approximate. Not to scale. For illustrative purposes only.