



39 Fitzpatrick Drive Staghorn Flat VIC

4 2 2

Superbly situated in sought-after Patrice Vale, this recently updated home has stunning features and an amazing feeling of space.

Consisting of four bedrooms - three with robes, and master with walk-in robe & en-suite, this home feels a world away from city life yet is close to all amenities.

The brand new kitchen is exceptional, with European appliances, waterfall granite benches, and contemporary pendant lighting. The home also features vaulted ceilings and solid timber flooring throughout the open plan living space.

Both of the bathrooms have been recently refurbished, including new shower screens and vanities.

Living in NE Victoria has the benefits of four distinct seasons and this house provides a choice of entertaining areas for each. There is the generous undercover decked entertaining area that

Land Size : 4.6 Acres
View : <https://www.wodongarealestate.com.au/sale/vic/north-eastern/staghorn-flat/residential/house/5836675>

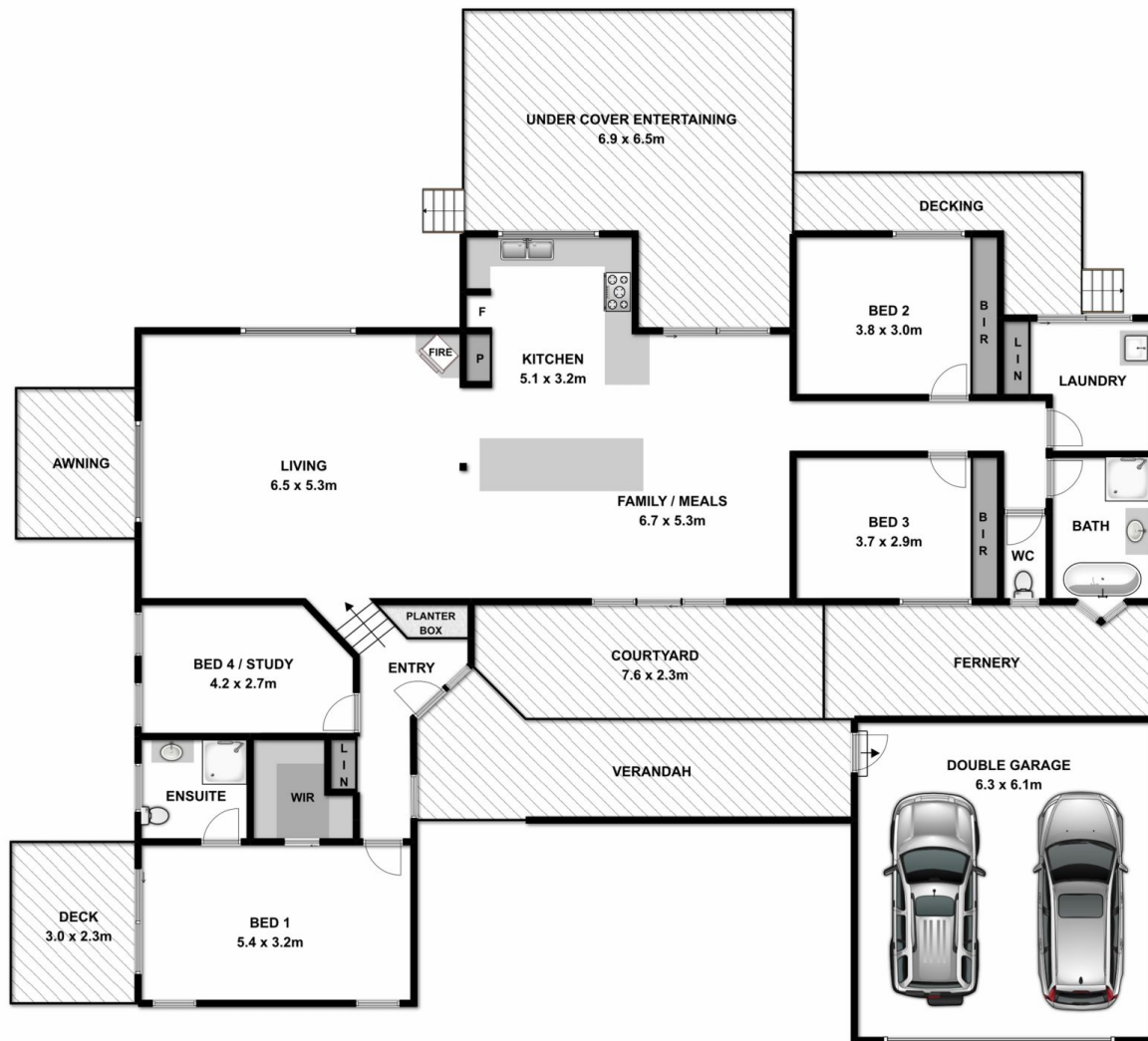

Measurements are approximate. Not to scale. For illustrative purposes only.



Measurements are approximate. Not to scale. For illustrative purposes only.