



7 Dominic Drive Wodonga VIC

4 2 2

This beautifully presented home is situated in a very prestigious estate. Built in an era when quality was paramount with every room being in generous size.

Features include:

Two large living zones being formal and informal. The formal lounge has an open fire place.

Serviceable Blackwood kitchen with ample bench space

Four large bedrooms, master with en-suite and built in robes, all other bedrooms with built in robes

Ducted heating and cooling for year round comfort

Family room has sliding doors opening on to an extensive paved area with undercover entertaining area and open pergola area.

Double lock up garage with remotes

Fully landscaped with low maintenance secure backyard.

Price : \$ 375,000

Land Size : 1028 sqm

View : <https://www.wodongarealestate.com.au/sale/vic/north-eastern/wodonga/residential/house/5836718>



Margy Meehan
0260 561 888

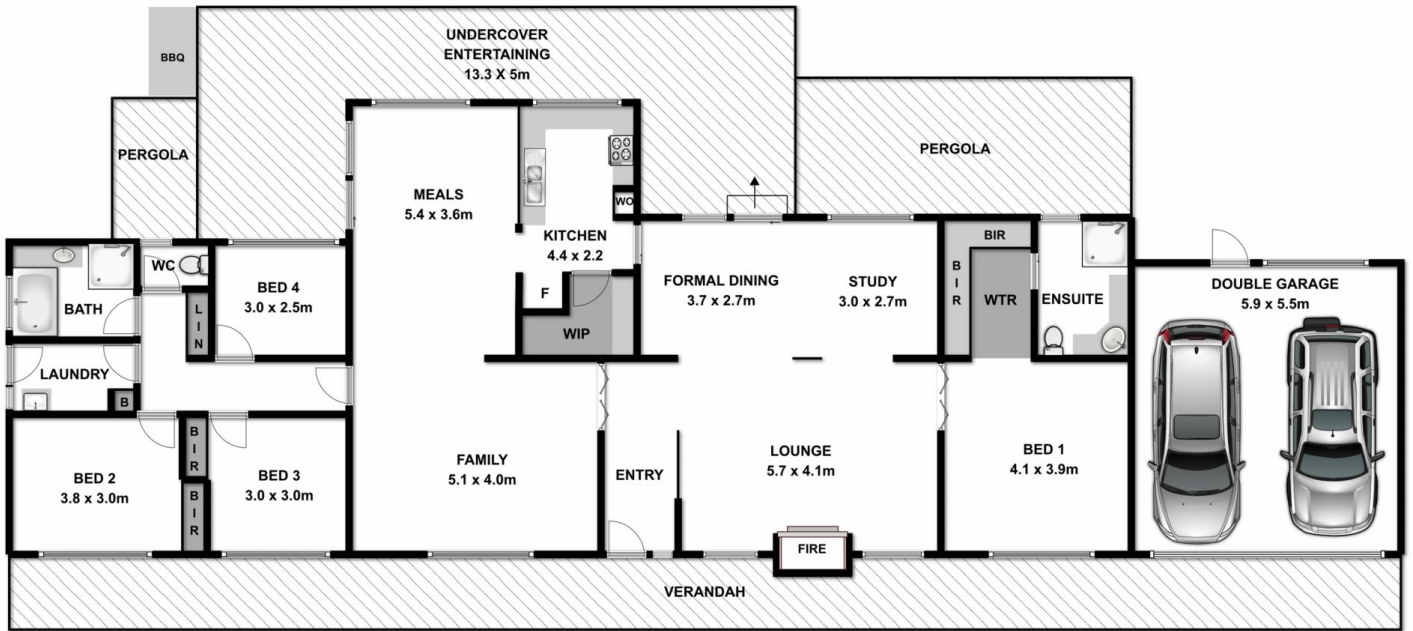

Measurements are approximate. Not to scale. For illustrative purposes only.