



**wodonga real estate
bestagents**



12 Skitch Street Wodonga VIC

This home located close to Birallee, sporting and educational facilities offers a great opportunity for the first home buyer or investor. Requiring some cosmetic upgrading and offering three bedrooms, this home is ready to purchase.

3 1

Price : \$ 170,000
Land Size : 674 sqm
View : <https://www.wodongarealestate.com.au/sale/vic/north-eastern/wodonga/residential/house/5836819>



Mark Rosevear
0260 561 888

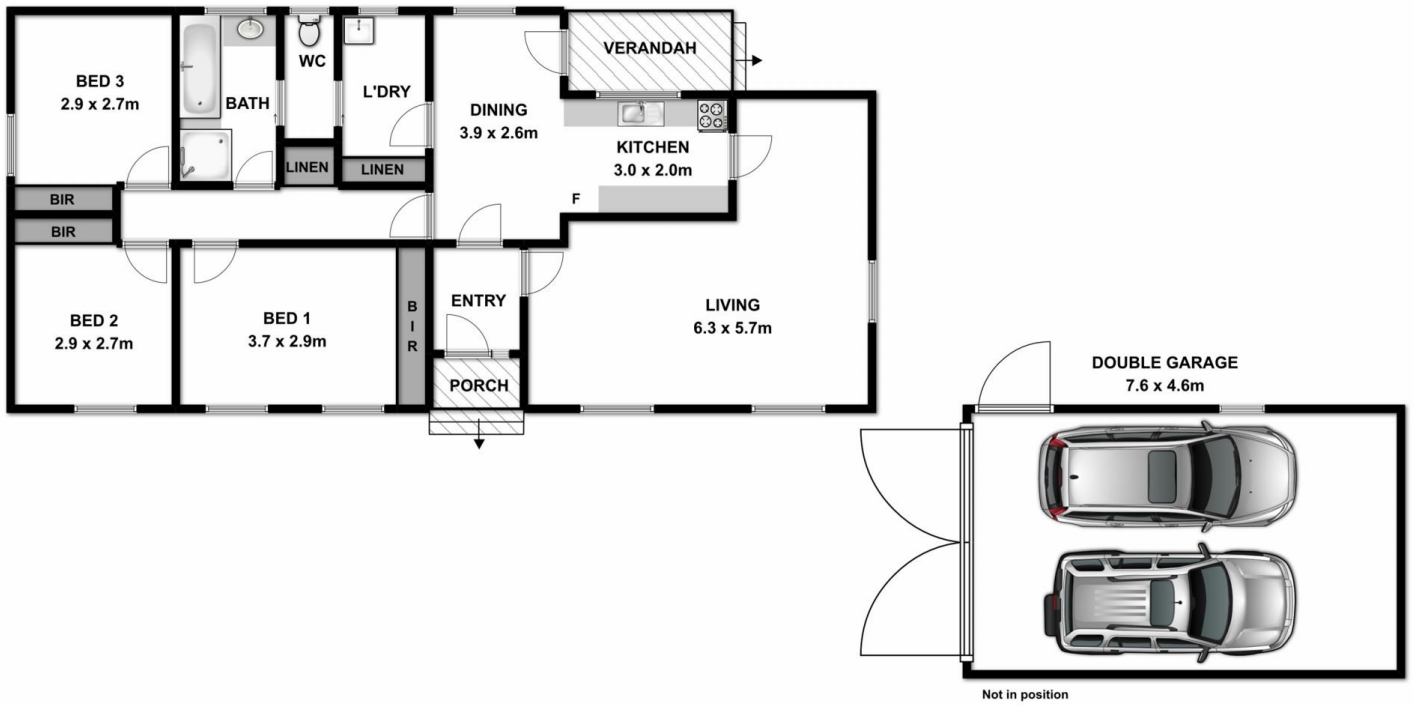

Measurements are approximate. Not to scale. For illustrative purposes only.