



15 Yarralumla Drive Wodonga VIC

4 2 2

Presented to perfection and recently professionally painted throughout this genuine family home is ready for a new owner to just unpack and enjoy. Well built in 2004 on a 604m² low maintenance allotment the many features include-

Two separate living areas of formal lounge and tiled family room

Large kitchen with dishwasher provision

Comforts of ducted gas heating and evaporative cooling

Double garage with remote and rear access to backyard

Fabulous location with easy access to schools, shops, transport and more

For investors expected rental return of \$370 - \$380 per week

Don't delay your inspection

Price : \$ 355,000

Land Size : 604 sqm

View : <https://www.wodongarealestate.com.au/sale/vic/north-eastern/wodonga/residential/house/5836833>



Clinton Harvey
0260 561 888

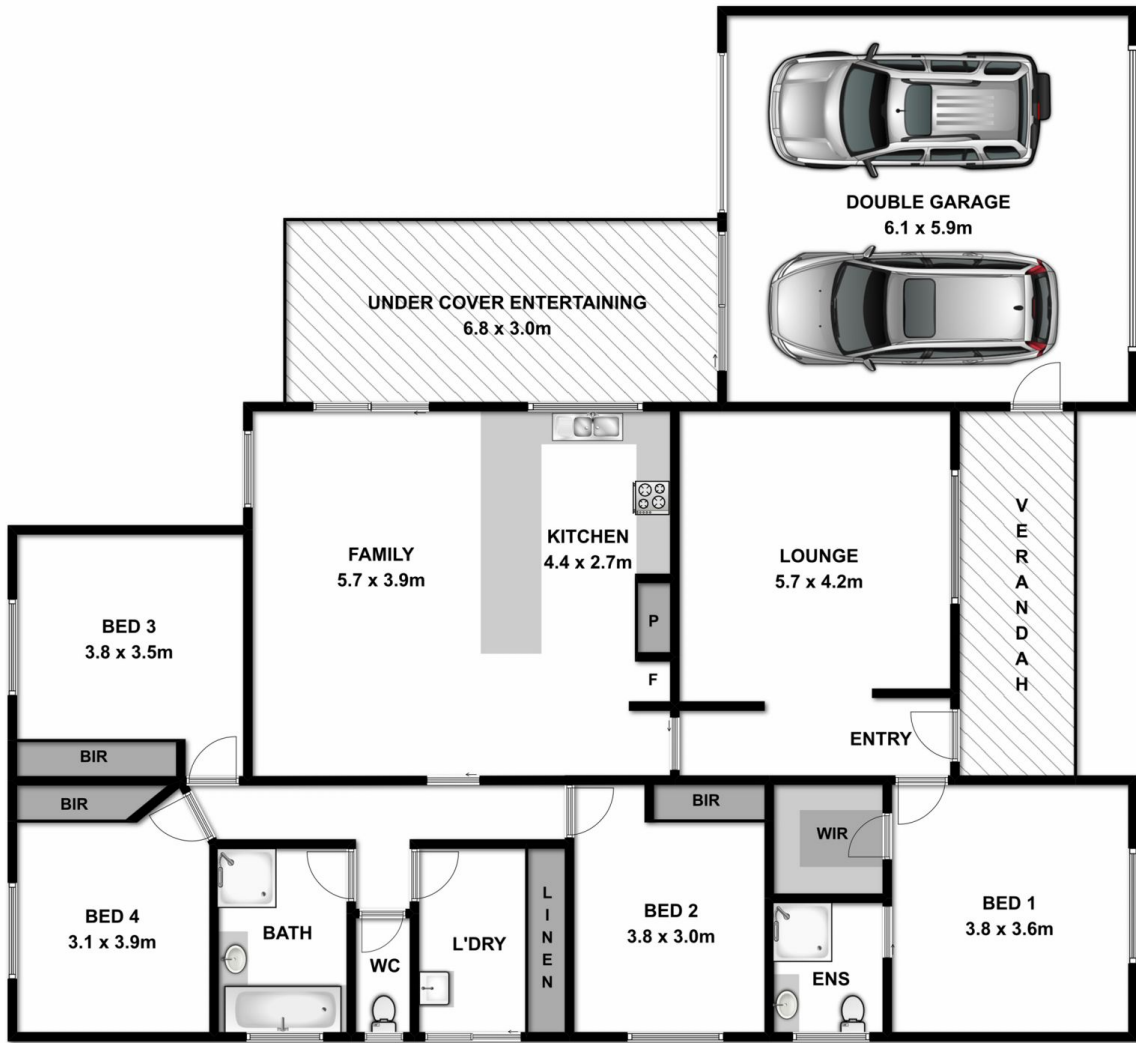

Measurements are approximate. Not to scale. For illustrative purposes only.