



### 6 Main Street Chiltern VIC

3 2 1

Situated on a sizeable 1200m<sup>2</sup> plus block with excellent rear yard access, this solid home has great space.

Featuring three generous bedrooms all with built in robes and serviced by the central family bathroom, the master offers an ensuite.

With new flooring throughout, carpets in the bedrooms and large lounge room, floating floors fitted in the high traffic areas and finished with quality window furnishings.

The outside space is terrific, with a drive garage plus plenty of rear yard access to accommodate a caravan or trailer etc. There is a good sized powered workshop approx.. 3 x 6 mt and room for another large shed (STCA).

With polished presentation, this neat and tidy home is an excellent home to be loved.

**Price** : \$ 252,000

**Land Size** : 1240 sqm

**View** : <https://www.wodongarealestate.com.au/sale/vic/north-eastern/chiltern/residential/house/5837047>

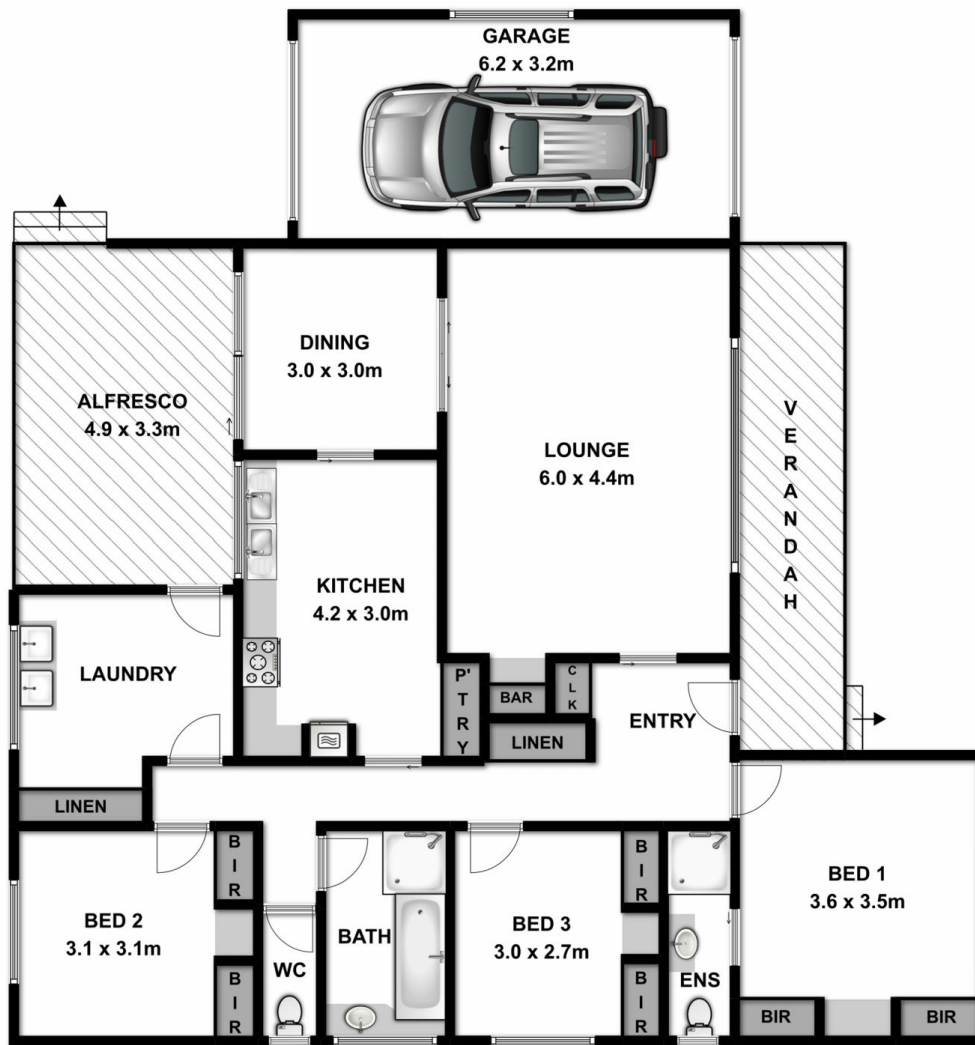

Measurements are approximate. Not to scale. For illustrative purposes only.