

65 Craig Drive Bellbridge VIC

5 3 4

Upon gracing this absolute first class contemporary home you are blissfully captivated by the incredible water views from every light filled living zone

The ultimate relaxed setting, sit back and appreciate the changes of seasons and every colour imaginable. You could be excused for feeling like you are on holidays forever.

So peaceful and quiet the many premium features include- Unrivalled alfresco entertaining area with extra downstairs outdoor entertaining

Grand two pak kitchen with large walk in pantry and Meile dishwasher

Master bedroom with private access to the alfresco, en-suite and three built in robes

Four other generous size bedrooms with built in robes

Study/sitting room or roll out a bed settee for an optional sleeping zone

Price : \$ 760,000

Land Size : 690 sqm

View : <https://www.wodongarealestate.com.au/sale/vic/north-eastern/bellbridge/residential/house/5837561>



Clinton Harvey
0260 561 888



FIRST FLOOR

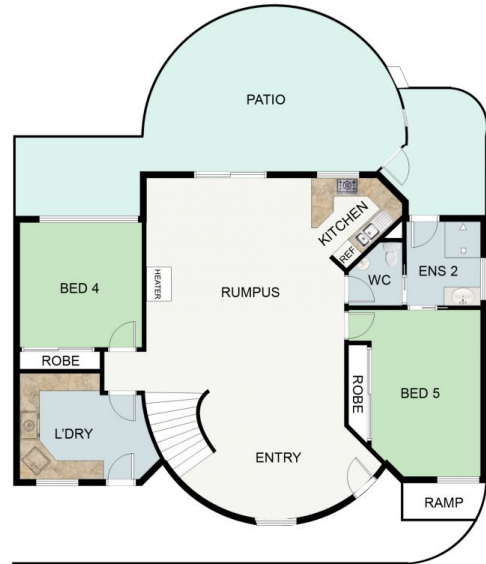

GROUND FLOOR

This floor plan including furniture, fixture measurements and dimensions are approximate and for illustrative purposes only. Boxbrownie.com gives no guarantee, warranty or representation as to the accuracy and layout. All enquiries must be directed to the agent, vendor or party representing this floor plan.

65 Craig Drive, Bellbridge