



### 38 Esposito Street Wodonga VIC

Build your dream home today!

One of the last blocks of its size in Riverside Estate with approx 987m<sup>2</sup> of land is waiting for you. The block has been levelled and charcoal retaining wall currently under construction, amazing views of surrounding hills. Imagine your family enjoying some of the unique features of Riverside Estate in the years ahead. Exercise will take on a new meaning when you can breathe the fresh air along the Estate's 1.6km looped walkway. This path will hug the banks of a quintessential Australian creek, sensitively revegetated to remove any signs of development. And nature lovers take note: your biggest challenge will be deciding which of the many tracks into Huon's Hill nature reserve you'll tackle on any given day. Or will it be the decision to swim, drop in a line to lure a fish or just enjoy a quiet picnic on a scenic bend of the Kiewa River, just a few hundred metres away from your new home. No wonder so

**Price** : \$ 185,000

**Land Size** : 987 sqm

**View** : <https://www.wodongarealestate.com.au/sale/vic/north-eastern/wodonga/residential/land/5837565>



WARNING - This document is a working document in the SPEAR approval process. It is subject to revision and change and therefore should not be relied on. If you have any questions about this document please contact the person from Spiire Australia Pty Ltd who gave you access to SPEAR / this document. SPEAR Ref: S0917628 16/12/2016 11:58 am

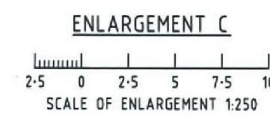
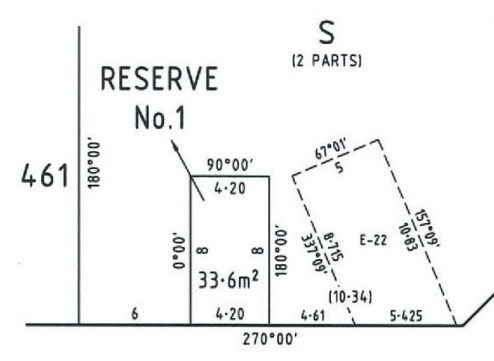
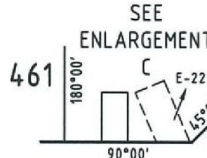
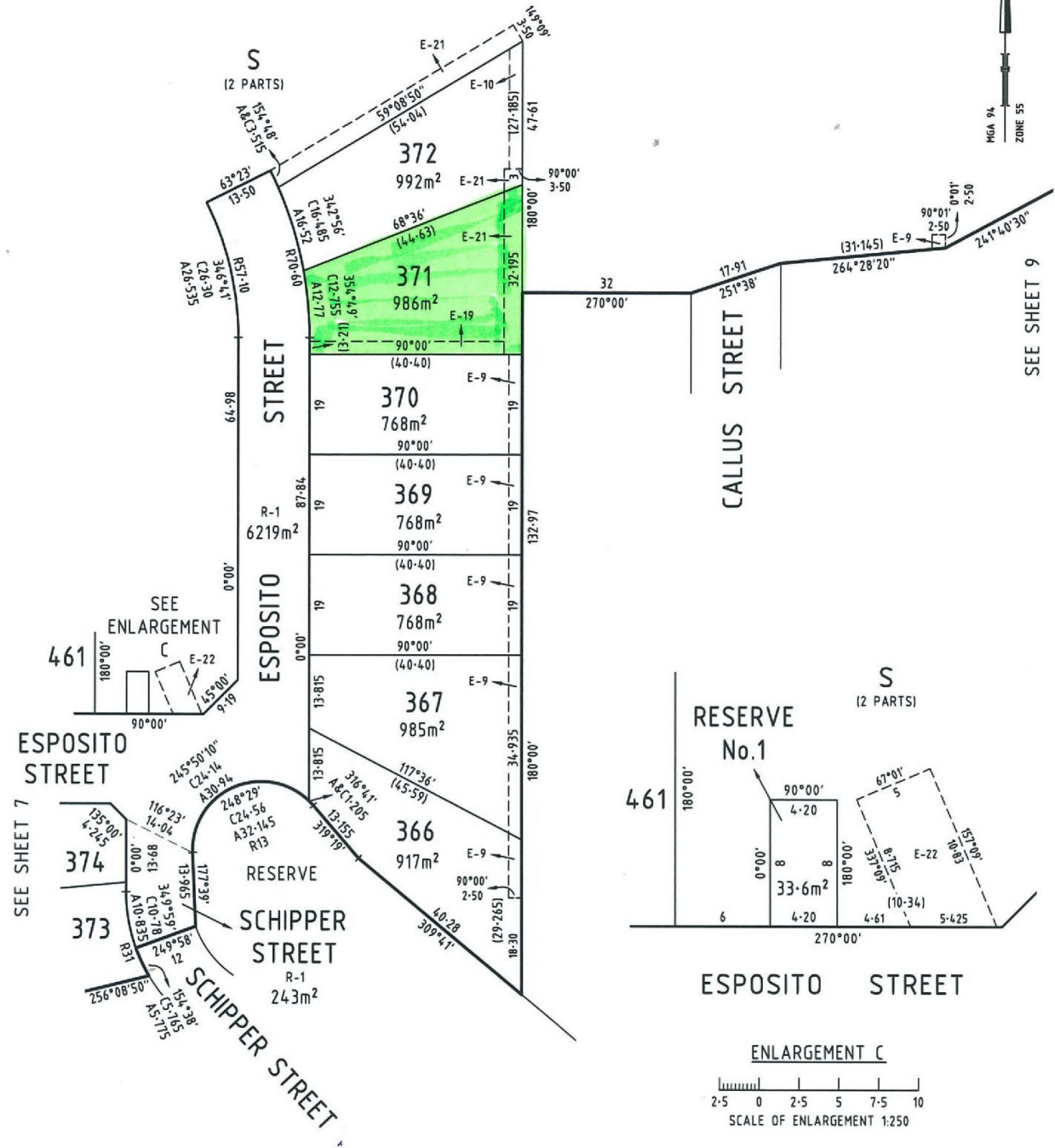

445 Townsend Street  
 PO Box 3400  
 Albury NSW 2640  
 T 61 2 6051 1300  
 spiire.com.au

SCALE 1:750  
 7.5 0 7.5 15 22.5 30  
 LENGTHS ARE IN METRES  
 Digitally signed by: Jason Robert Hay (Spiire Australia Pty Ltd - Albury),  
 Surveyor's Plan Version (3),  
 23/11/2016

ORIGINAL SHEET SIZE: A3  
 Digitally signed by: City of Wodonga,  
 07/12/2016,  
 SPEAR Ref: S0917628