



6 Woodbridge Street Killara VIC

4 2 2

Why build when you could move into this amazing new home in Riverside Estate? Currently under construction is this quality home is set on approx. 603m² and has it all, built to accommodate families or retirees who don't want to compromise on space.

Master Suite with walk in robe, large ensuite with separate toilet and tiles to the roof, remaining three bedrooms with built in robes. Spacious bathroom with modern freestanding bath and tiles to the roof.

Open plan kitchen with freestanding 900m cooktop and oven, family and meals area with a large walk in pantry and a separate living zone at the front of the home. Ample storage space in the laundry and extra storage in the hall. Double lock up garage and side gate access for the boat or caravan.

Close to picturesque walking tracks and the Kiewa River
Don't delay come and see why so many people are calling

Price : \$ 451,819
Land Size : 603 sqm
View : <https://www.wodongarealestate.com.au/sale/vic/north-eastern/killara/residential/house/5837789>



Margy Meehan
0260 561 888



Vanessa Meehan
0260 561 888

FIGURED DIMENSIONS TAKE PRECEDENCE OVER SCALED DIMENSIONS. THE CONTRACTOR SHALL VERIFY ALL DIMENSIONS ON SITE BEFORE BEGINNING ANY WORK. ALL BUILDING WORKS ARE TO COMPLY WITH THE BCA AND APPLICABLE AUSTRALIAN STANDARDS AS WELL AS LOCAL AUTHORITY REQUIREMENTS.

LIVING 19.84 sq (184.30 sqm)
 GARAGE 4.730sq (43.92 sq m)
 ALFRESCO/PORTICO 4.33 sq (40.23 sq m)
 UNDER ROOF 31.00sq (288.04 sq m)

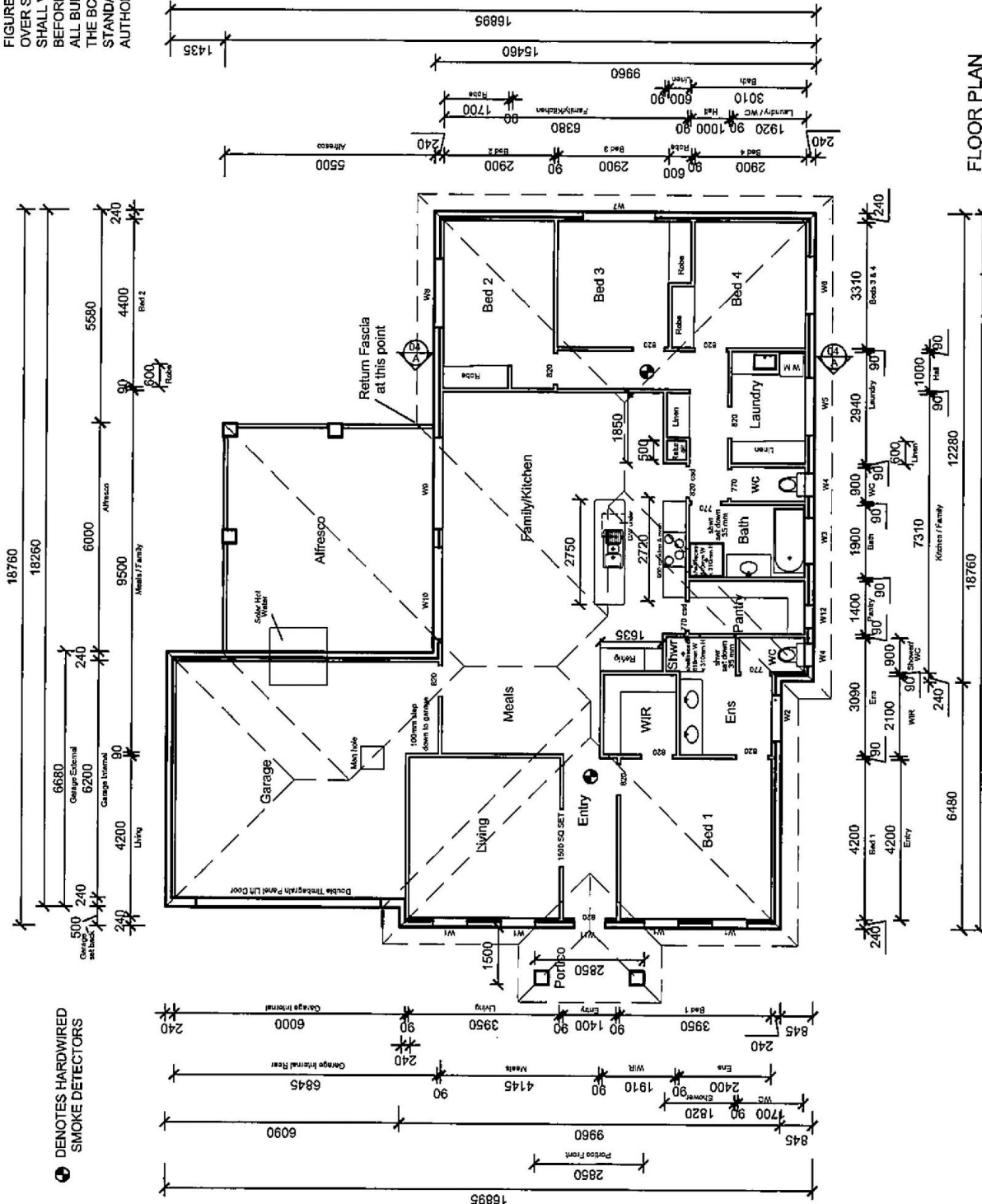

FLOOR PLAN

Drawn	L.S.	Page No.	02
Approved	L.S.	Lab No.	102
Date	15/05/19		
Scale	1/100		

FLOOR PLAN
1/100

PROPOSED RESIDENCE FOR
 STREETAL PTY LTD
 LOT 428 WOODBRIDGE STREET
 KILLARA