



6 Blackburn Close Wodonga VIC

3 2 2

Three bedroom home featuring a his and her walk in robe to the master and an en-suite. Large family /meals area, kitchen with pantry and a dishwasher, full bathroom with an extra powder room and an alfresco area for outside dining. Lots of storage space with huge spaces in both the laundry and the garage. The Grove is situated in the new White Box Rise Estate and has a private park and BBQ area designed for the close knit community it houses. It also offers a secure gated precinct giving extra security for you and your belongings.

View : <https://www.wodongarealestate.com.au/lease/vic/north-eastern/wodonga/residential/house/5840598>

SERVICES LEGEND

- (ST) STORMWATER
- (SW) SEWER
- (E) ELECTRICAL
- (T) TELSTRA
- (G) GAS
- (W) WATER
- (H) HYDRANT
- (P) POWER POLE

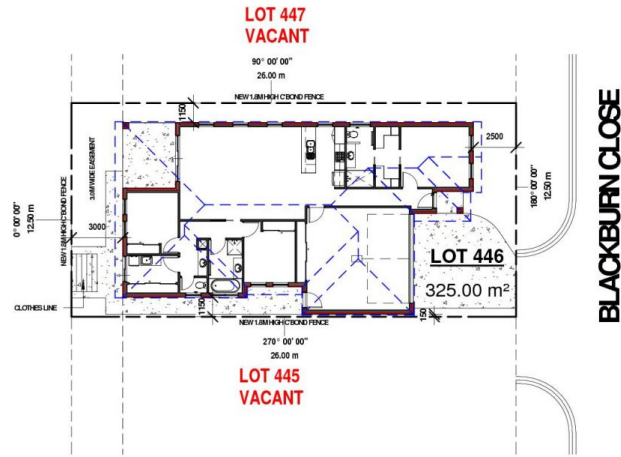

1 Site
1:200

WARNING The is sole property of Cavalier Homes Albury/Wodonga PTD LTD, and may not be used in whole or in part without written or formal consent from Cavalier Homes Albury/Wodonga PTD LTD. Legal action will be taken against any person's infringing the copyright.

Rev. No.	Revision Description	Rev. Date.



CONCEPT DESIGN

**PROPOSED 3 BED RESIDENCE
AT LOT 446 BLACKBURN CLOSE
WODONGA VIC 3690**

WODONGA OFFICE
20 FIRESTONE WAY
WODONGA VIC 3690
PH 03 6099 3366 FAX 03 6099 3322
CONTRACT APPROVAL
AS PER CONDITIONS OF CONTRACT THESE DRAWINGS
ARE A REPRESENTATION OF WHAT IS TO BE BUILT AND
ITEMS NOT SHOWN ON THIS DOCUMENT OR IN
SPECIFICATION ARE DEEMED NOT TO BE PART OF THE
CONTRACT.

WE APPROVE THESE DRAWINGS CORRECT AS PER CONTRACT

Client: _____ Date: _____
 Date: _____
 Date: _____
 Date: _____

Job No.: IA043
 Revision No.: CD01
 Date: 22-10-10
 Drawn By: MS
 Scale: 1 : 200
 Sheet No.: 1