



10 Orchard Grove Beechworth VIC

3 2 2

Situated in the historic town of Beechworth close to the lovely Lake Sambell and quaint main street which features a variety of specialty shops, including the iconic Beechworth Bakery, Lolly Shop, Ice Creamery and Beechworth Gold.

A modern style three bedroom brick veneer home ideally located close to shops, schools, sporting facilities, Beechworth Hospital and more.

With plenty of natural light, this home offers an open plan living/kitchen/dining layout located to the rear of the home.

The many other features include-

- * Electric kitchen with dishwasher and island bench/breakfast bar.
- * Spacious open plan living and ample dining space with the main living area stepping out to an enclosed back yard.
- * The main bedroom is complimented by the walk in robe

Price : \$ 500,000
Land Size : 624 sqm
View : <https://www.wodongarealestate.com.au/sale/vic/north-eastern/beechworth/residential/home/6779353>



Silviya Saric
0260 561 888

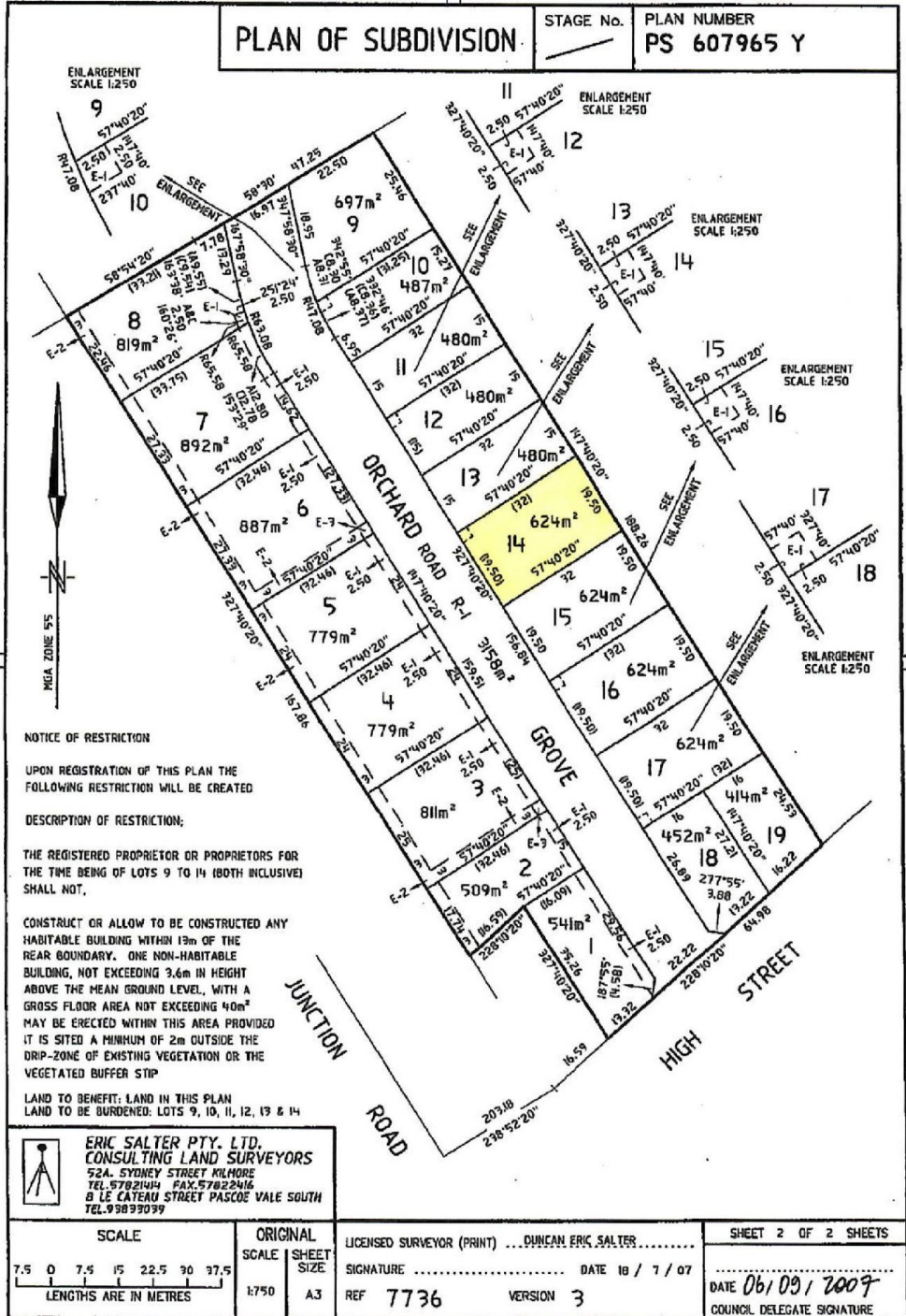

10 110 120 130 140 150 160 170 180 190 200 210 220 230 240 250mm