



**wodonga real estate  
bestagents**



**15-17 Church Street Wodonga VIC**

1 1

Are you a romantic wishing to fulfil your dreams, or do you have a vision to create on this prime 2800m<sup>2</sup> (approx.) parcel of land with the Circa 1869 church positioned in the heart of Central Wodonga.

Measuring with an approximate frontage of 39.6 metres x 70.7 metres depth, the 2800m<sup>2</sup> allotment zoned residential is largely flat until the land drops away at the rear facing onto the immensely popular Sumsion Gardens.

Surrounded by excellent properties/neighbours the location offers all conveniences. Enjoy nearby fine dining, cafés, shops, transport and more.

This life changing opportunity must assume your immediate energy, let us service you with our unbridled enthusiasm.

Note:

? The purchase price is plus GST

? See the attached Statement of Information for a price

**Land Size** : 2800 sqm

**View** : <https://www.wodongarealestate.com.au/sale/vic/north-eastern/wodonga/residential/house/7178185>



**Clinton Harvey**  
**0260 561 888**

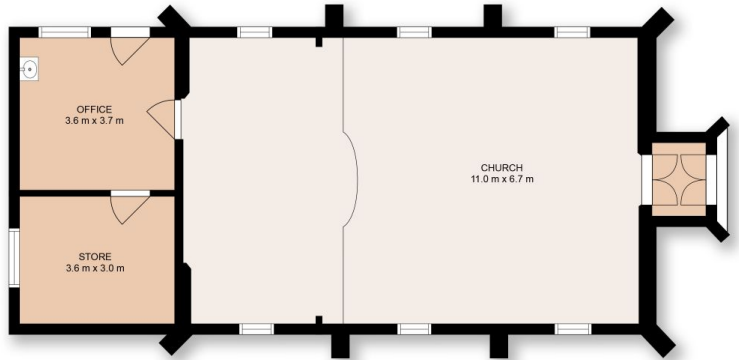
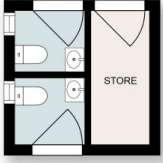

This floor plan including dimensions are approximate and are for illustrative purposes only and should be used purely as a guide. No guarantee can be given to accuracy of the information contained, and interested parties should conduct their own enquires.