



### 3 Rapsey Court Wodonga VIC

3 1 1

Explore the potential of this affordably priced residence, situated in the thriving West Wodonga area. Situated in a low traffic court, this home is just minutes away from the Birallee shopping centre, various schools, scenic walking paths, park and the local Leisure Centre.

Positioned on an 809m<sup>2</sup> (approx.) plot, this property invites first-time buyers or investors to shape their ideal home on a blank canvas. Explore the potential to subdivide and built another townhouse or unit on the block (STCA).

Enjoy the convenience of proximity to the Birallee Tavern, nearby walking paths and skate park for family outings and the Local Raiders sports club, Cricket Club and Hockey fields for weekend sports enthusiasts. With ample space for recreational activities, envision a delightful Christmas with kids playing in the court and enough room for a trampoline

**Price** : \$ 370,000  
**Land Size** : 809 sqm  
**View** : <https://www.wodongarealestate.com.au/sale/vic/north-eastern/wodonga/residential/house/7839782>



**Silviya Saric**  
**0260 561 888**

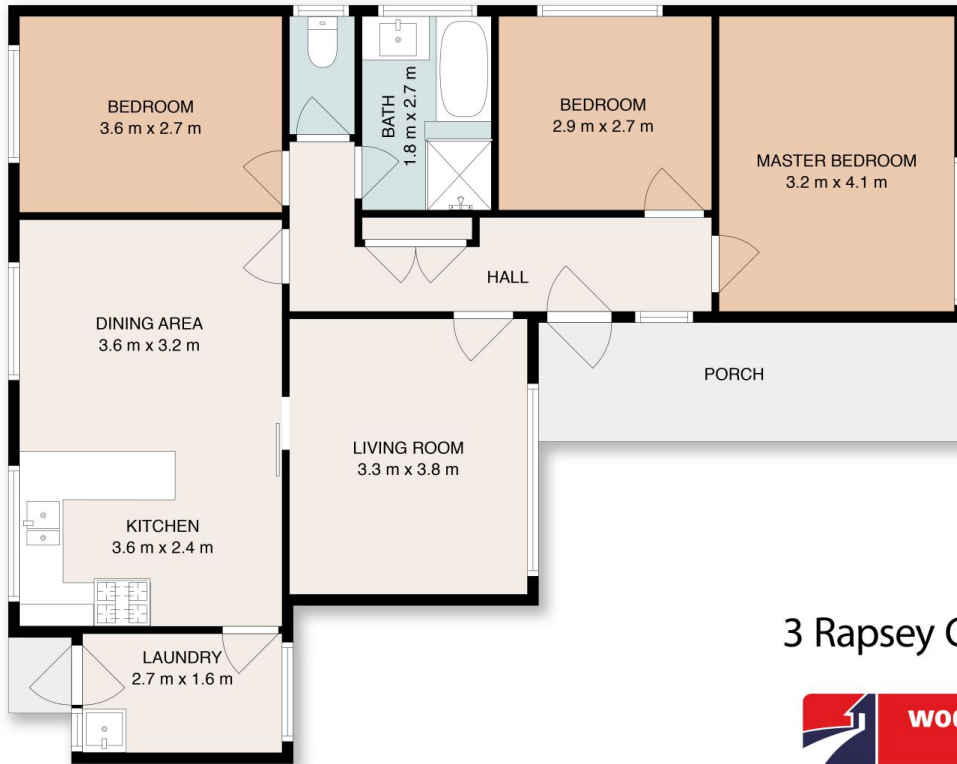

## 3 Rapsey Court, Wodonga



This floor plan including dimensions are approximate and are for illustrative purposes only and should be used purely as a guide. No guarantee can be given to accuracy of the information contained, and interested parties should conduct their own enquires.