

201 Gayfer Road Chiltern VIC

1 🏠 1 🚗 1 🚘

The perfect blend of rural tranquillity and urban convenience, this idyllic North East Victoria property offers the perfect setting for horse enthusiasts.

Spanning an impressive 53.82 hectares (133 acres) of gently rising to hilly countryside bordering national and state parks, this expansive property showcases rural beauty and multifaceted working spaces.

Ideally, the new owners of Appletree Equestrian Centre would carry on operating the business as a successful enterprise, as the current facilities are exceptional, featuring state-of-the-art equipment and remarkable attention to detail.

Significant investment has already been made, however, this rural retreat located on the outskirts of the historic gold rush town of Chiltern, also presents as a blank canvas, allowing any number of agricultural or other pursuits to be

Price : \$1,995,000
Land Size : 54 ha
View : <https://www.wodongarealestate.com.au/sale/vic/north-eastern/chiltern/residential/rural/8035457>



Clinton Harvey
0260 561 888



Clint Ilesley
0260 561 888

Upper Level

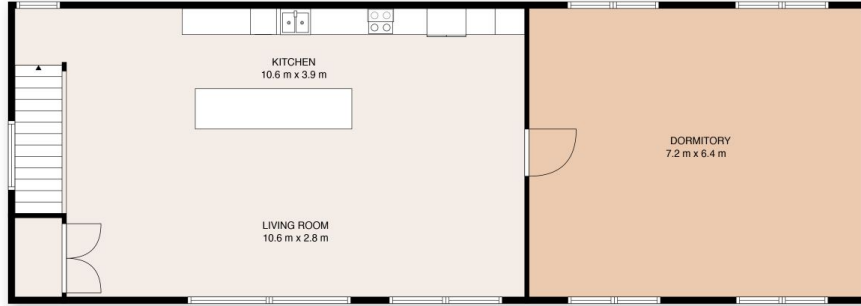

Bunkhouse

Lower Level

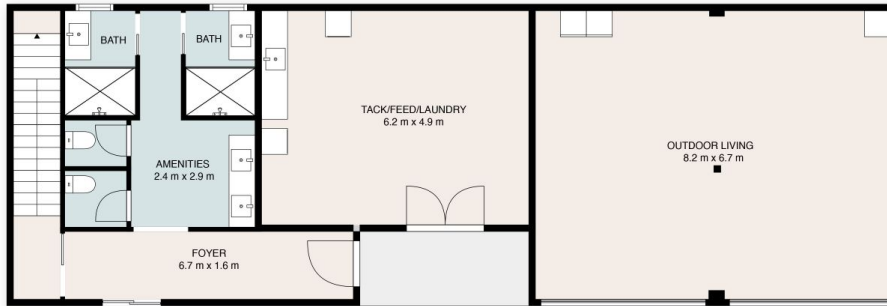

This floor plan including dimensions are approximate and are for illustrative purposes only and should be used purely as a guide. No guarantee can be given to accuracy of the information contained, and interested parties should conduct their own enquires.

201 Gayfer Road,
Chiltern



Stables

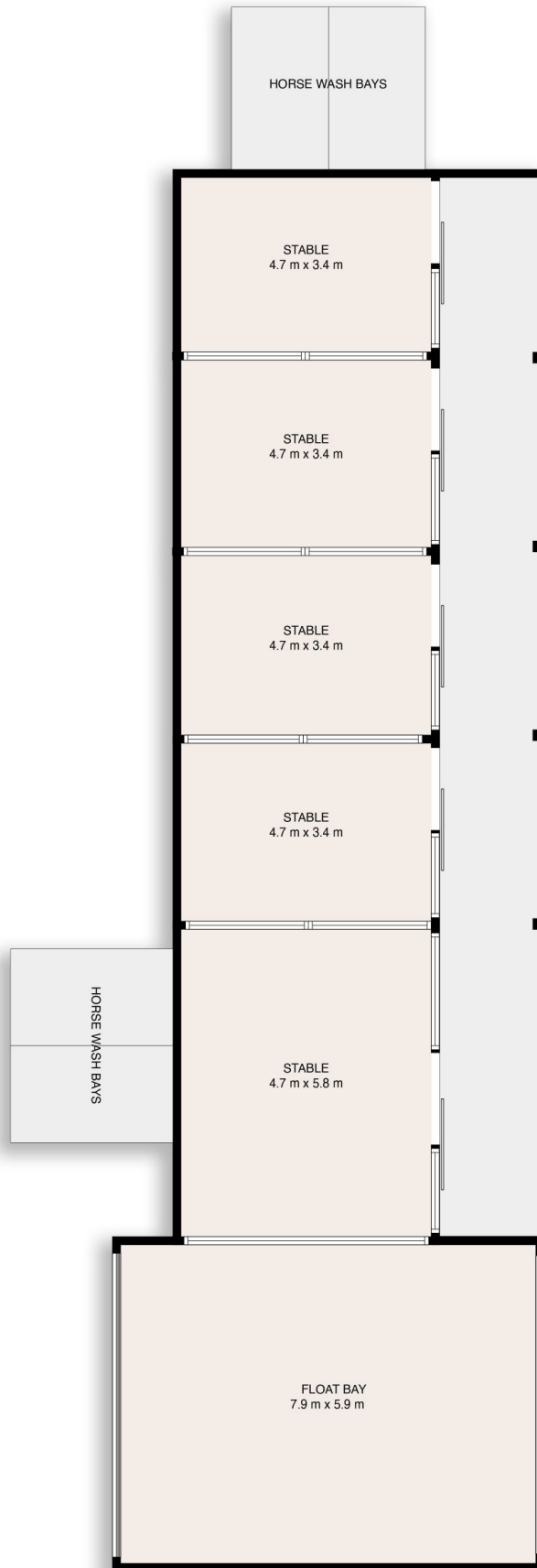

This floor plan including dimensions are approximate and are for illustrative purposes only and should be used purely as a guide. No guarantee can be given to accuracy of the information contained, and interested parties should conduct their own enquires.